

MODEL: WB-M5-10620K3



Introducing the M5 Bargun, an advanced beverage dispensing solution that merges innovative design with cutting-edge technology. It features a sleek matte finish and a redesigned handle for a superior pouring experience, achieving a remarkable 2.5 ounces per second in dispensing speed. The lightweight and ergonomic design enhances usability, while the Newton CFV Control Flow Valves allow precise pressure regulation for various beverages.

The M5 simplifies maintenance with an easy shut-off feature and streamlined access to components. It automatically calibrates to ensure optimal Brix ratios, even accommodating viscous products. By reducing the number of parts, the M5 enhances operational efficiency and saves space.

PRODUCT OPTIONS AND ACCESSORIES

- M5 Parts Kit
- M5 Orifice Parts Kit
- Hose Hanger Kit Part Number: HH-KIT-1

PRODUCT FEATURES

- Flow Rate: 2.5oz per second dispense rate due to optimized fluid passages in the handle.
- Integrates Seamlessly: Works with any bag-in-box system.
- Newton CFV Control Flow Valves: Precise pressure regulation post-manifold, allows each flow channel for syrup, water, and carbonated water to operate at targeted pressures tailored for specific Brix ratios.
- Innovative Brix Ratio Calibration: Orifices are engineered for various beverage specifications, ensuring a calibrated Brix ratio right out of the box.
- Simplified Serviceability: Toggle shut-off feature and tube collector with a level action mechanism streamlines maintenance.
- SKU Optimization: Simplifies parts inventory management for both the handle and manifold.
- Lightweight Design: Streamlined bill of materials focuses on hardware efficiency, making the M5 light and easy to use.
- Ergonomic Grip: The low-profile handle design ensures a comfortable grip and enhances user comfort during operation.

AIA FILE NUMBER:

ITEM NUMBER:

MODEL: WB-M5-10620K3

WEIGHTS & DIMENSIONS	
Width	7 in
Depth	42 in
Height	2.5 in
Weight	2.5 lb

SHIPPING DETAILS	
Ship Width	14 in
Ship Depth	12 in
Ship Height	4 in
Ship Weight	3.5 lb
Number of Shipment Parcels	1
Ship Method	Small Parcel (FedEx, UPS, DHL)
Shipping Package Type	Pieces
Shipping Origin Zip Code	95688
Freight Class (NMFC)	250
Quick Ship Product	No
Ship Lead Time	84

WATER, PLUMBING, AND DRAINAGE SPECS	
Water Line Required	Yes
Water Connection Source Type	Plumbed Water Line
Water Inlet Size	0.25 in
Water Inlet Pressure Minimum**	60 PSI
Water Inlet Pressure Maximum	105 PSI
Drain Line Required	Yes
Drain Location	Variable
**Pressure Remarks	Pump Reg: Min 60psi Diet / Min 70psi Sugars / Min 80psi for line runs >50ft & most viscous syrups.

PRODUCT CERTIFICATIONS	
	
	

ENERGY SPECS	
Primary Energy Type	No Energy Utilities
Dedicated Circuit Required	No

ADDITIONAL SPECIFICATIONS	
Number of Servable Beverages	10

BIDDING SPECIFICATIONS	
Bidding Specifications Not Available.	

WUNDERBAR M5 BARGUN - 10 BUTTON, BLACK, 6 CARB, 2 NON-CARB, 0 PREMIX, 3 FEET

MODEL: WB-M5-10620K3

TECHNICAL DRAWING

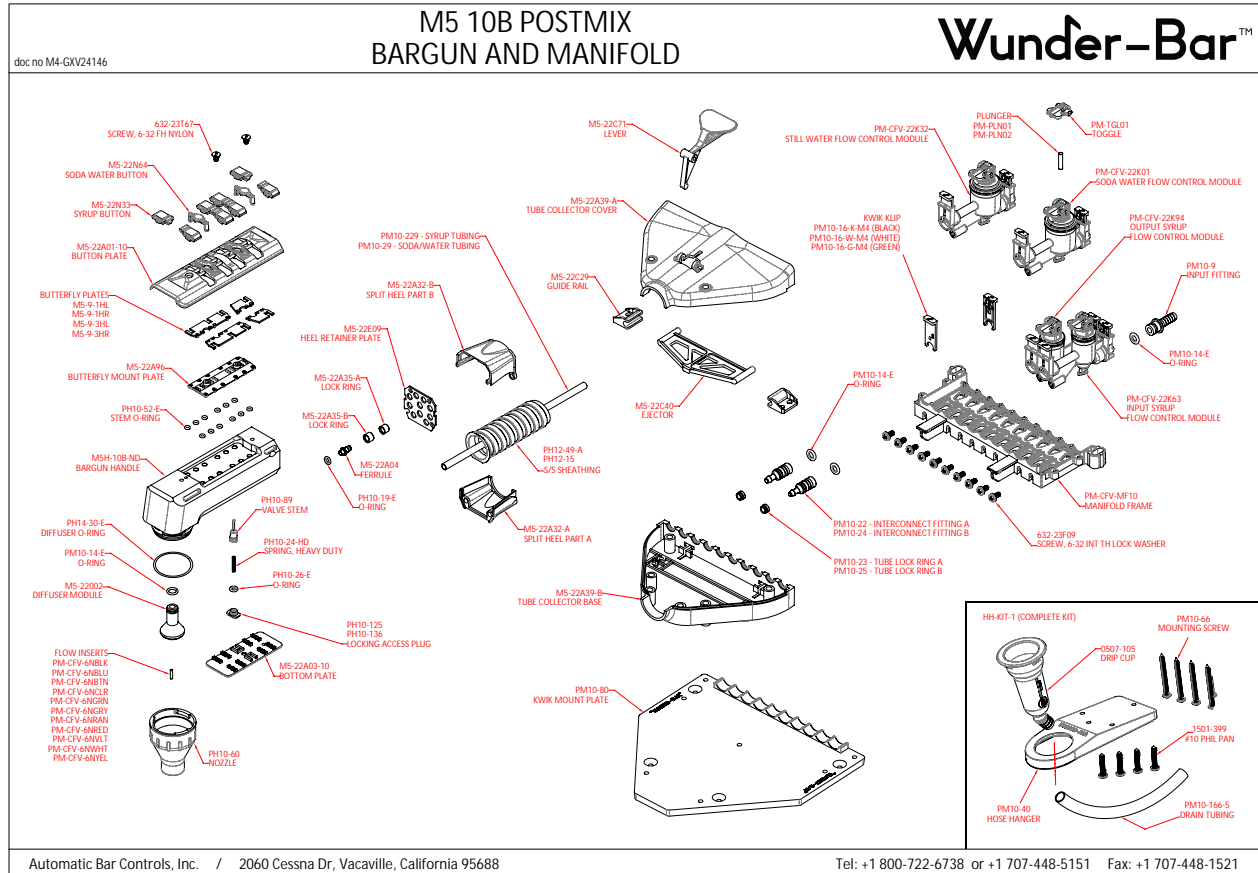

Wunderbar reserves the right to modify specifications or discontinue models without incurring obligation. Dimensions nominal.

Document Auto-Generated
November 12, 2024