

Wunder-Bar Dispensing Systems

WBM-220-2.5
HANDLE AND MANIFOLD

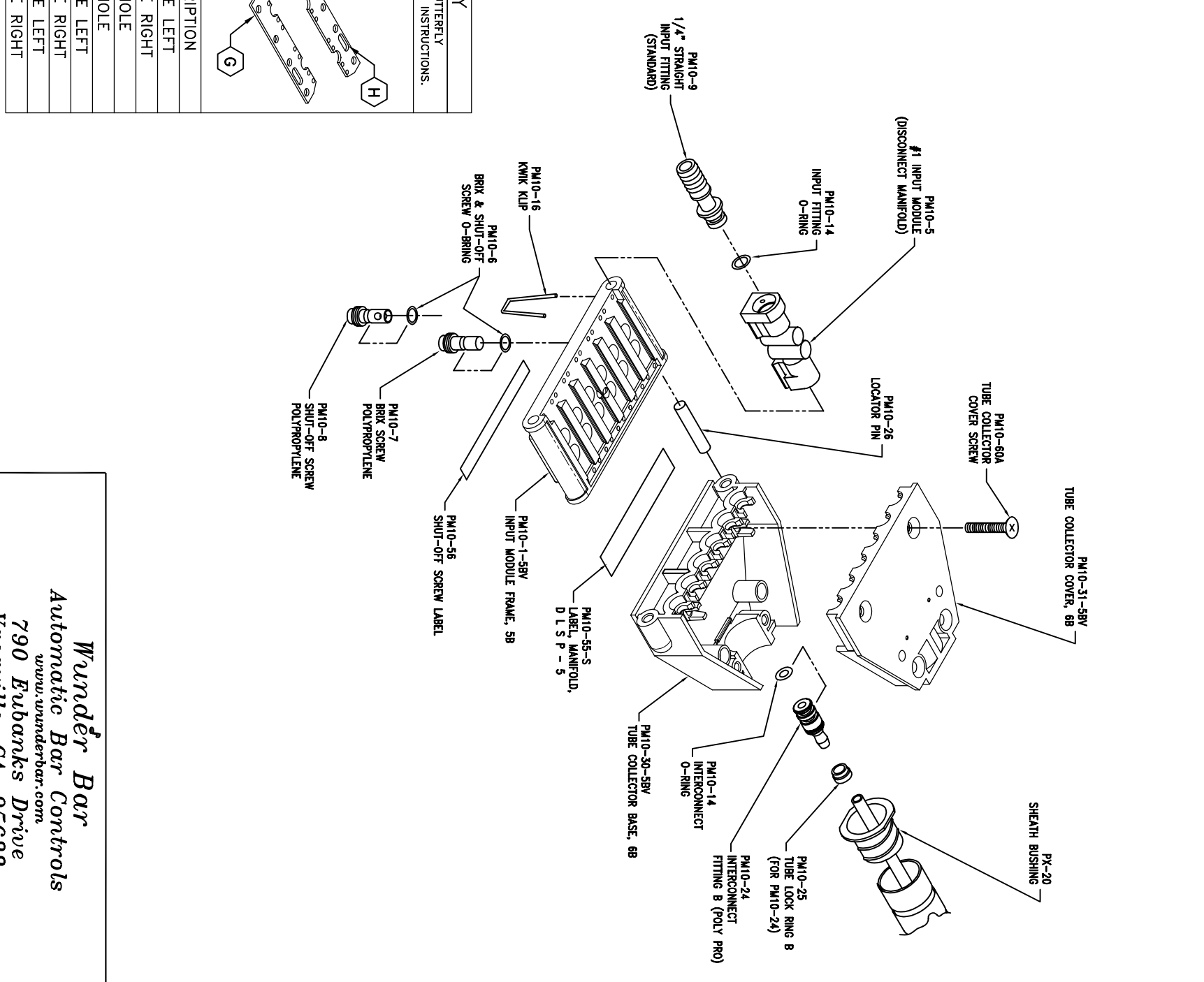

BUTTERFLY PLATE KEY
FOR OPTIONAL CARBONATED AND NON-CARBONATED BUTTERFLY CONFIGURATIONS SEE BUTTERFLY MAP IN INSTALLATION INSTRUCTIONS.

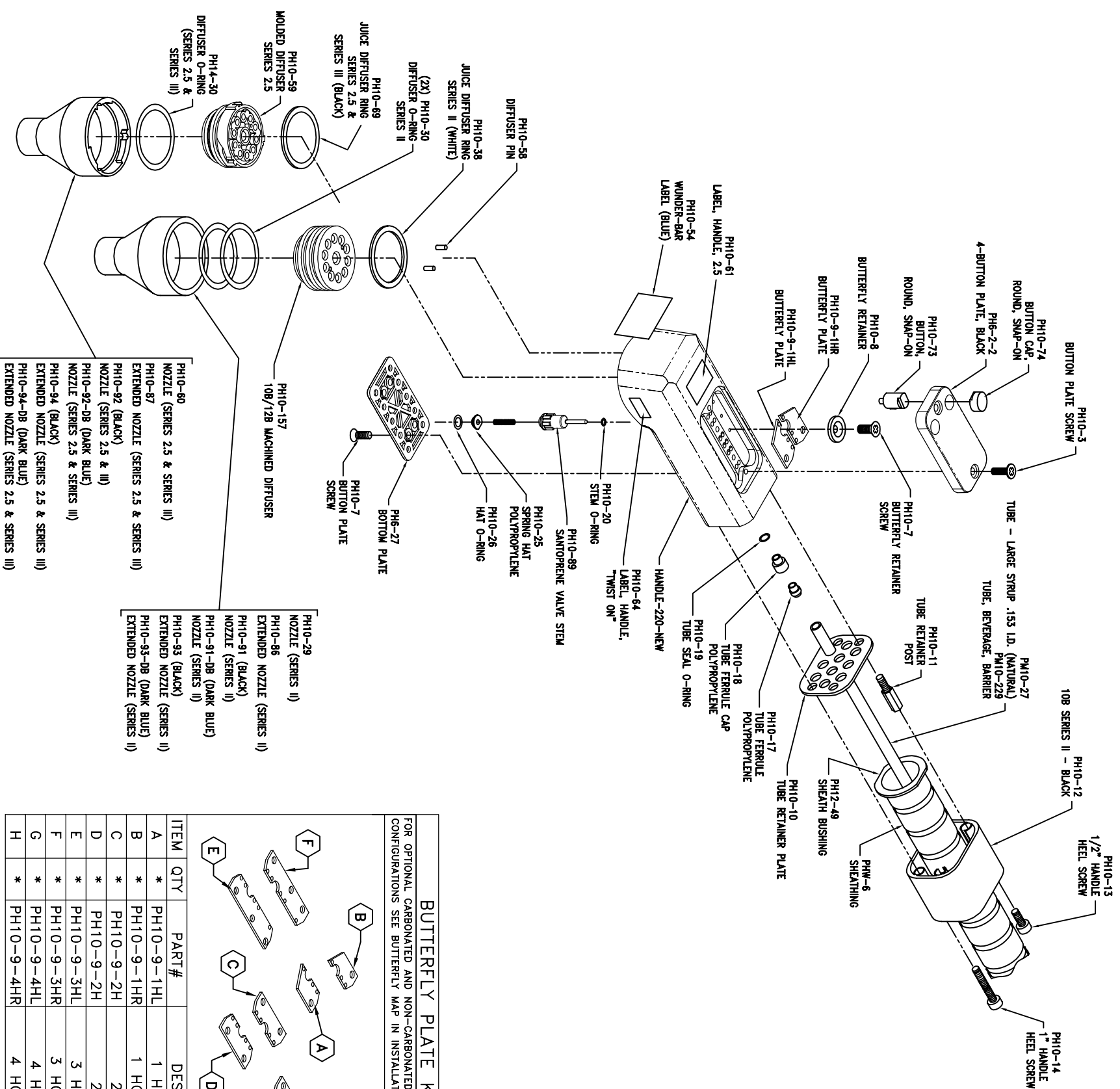
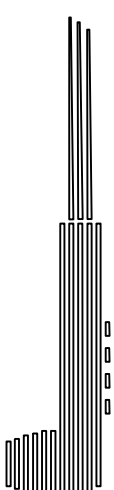
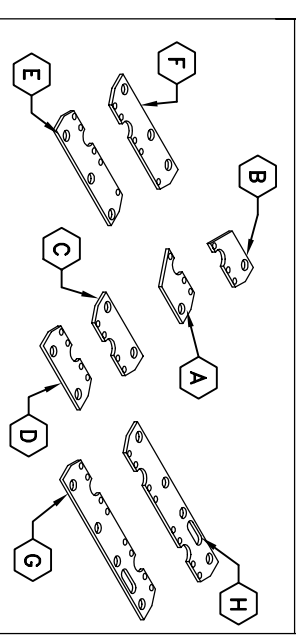

ITEM	QTY	PART #	DESCRIPTION
A	*	PH10-9-1HL	1 HOLE LEFT
B	*	PH10-9-1HR	1 HOLE RIGHT
C	*	PH10-9-2H	2 HOLE
D	*	PH10-9-2H	2 HOLE
E	*	PH10-9-3HL	3 HOLE LEFT
F	*	PH10-9-3HR	3 HOLE RIGHT
G	*	PH10-9-4HL	4 HOLE LEFT
H	*	PH10-9-4HR	4 HOLE RIGHT

0560054.DWG / 6-16-2008

Wunder Bar
Automatic Bar Controls
www.wunderbar.com
790 Eubanks Drive
Vacaville, CA. 95688
PHONE: 707-448-5151 FAX: 707-448-1521